

43961- Integral D1 DALI/8ADD/RELAY - Changing DALI Addresses

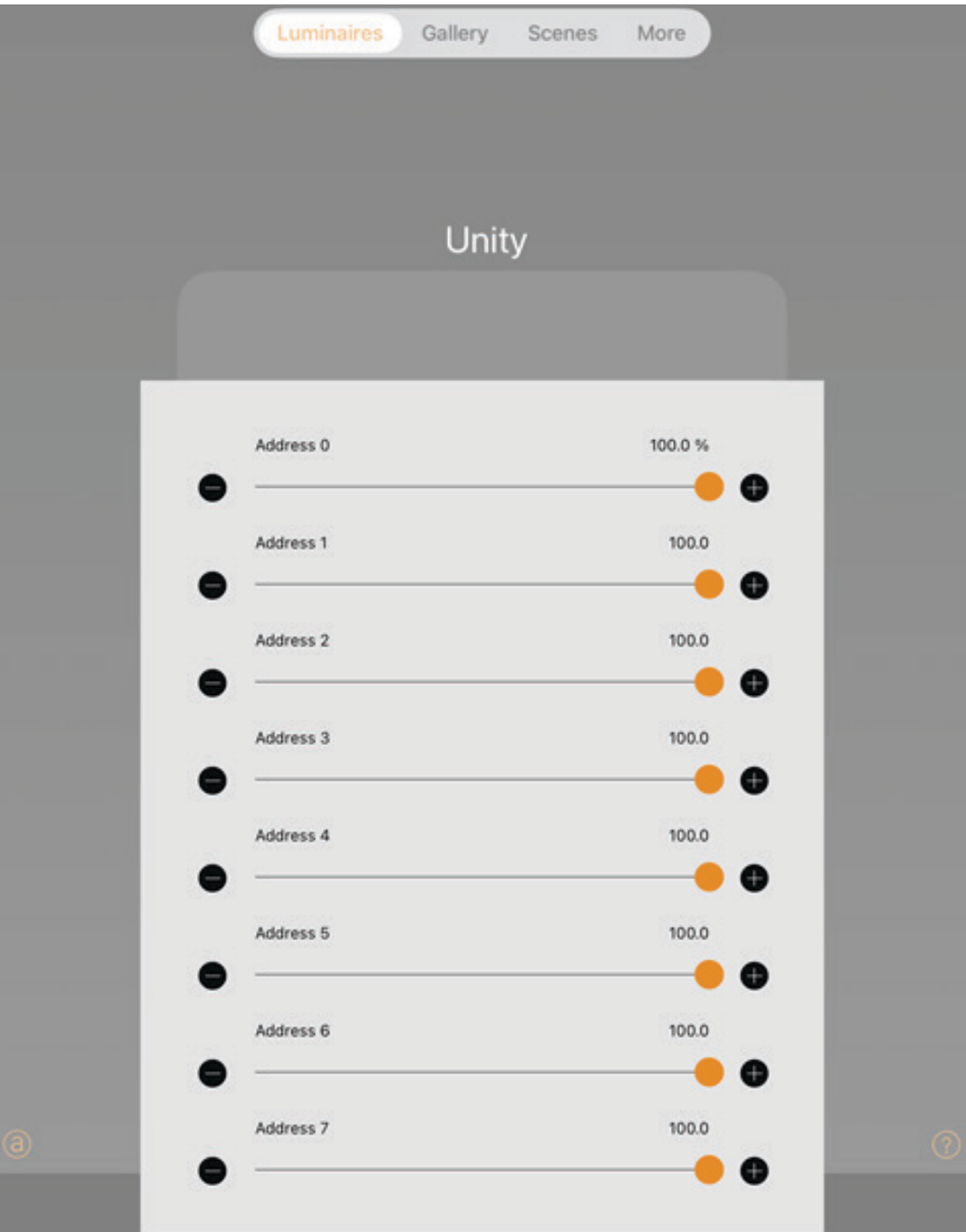

Hold your finger over the D1 icon to bring up dimming options. In this profile upto 8 DALI addresses are individually controllable. Addresses are listed from Address 0 (A0) to Address 7 (A7). The dimmers listed directly control the DALI devices based on what DALI address they have. In this way you can individually control upto 8 DALI addresses from D1. See next details for how to see what DALI devices have which address and how to change thier Address.

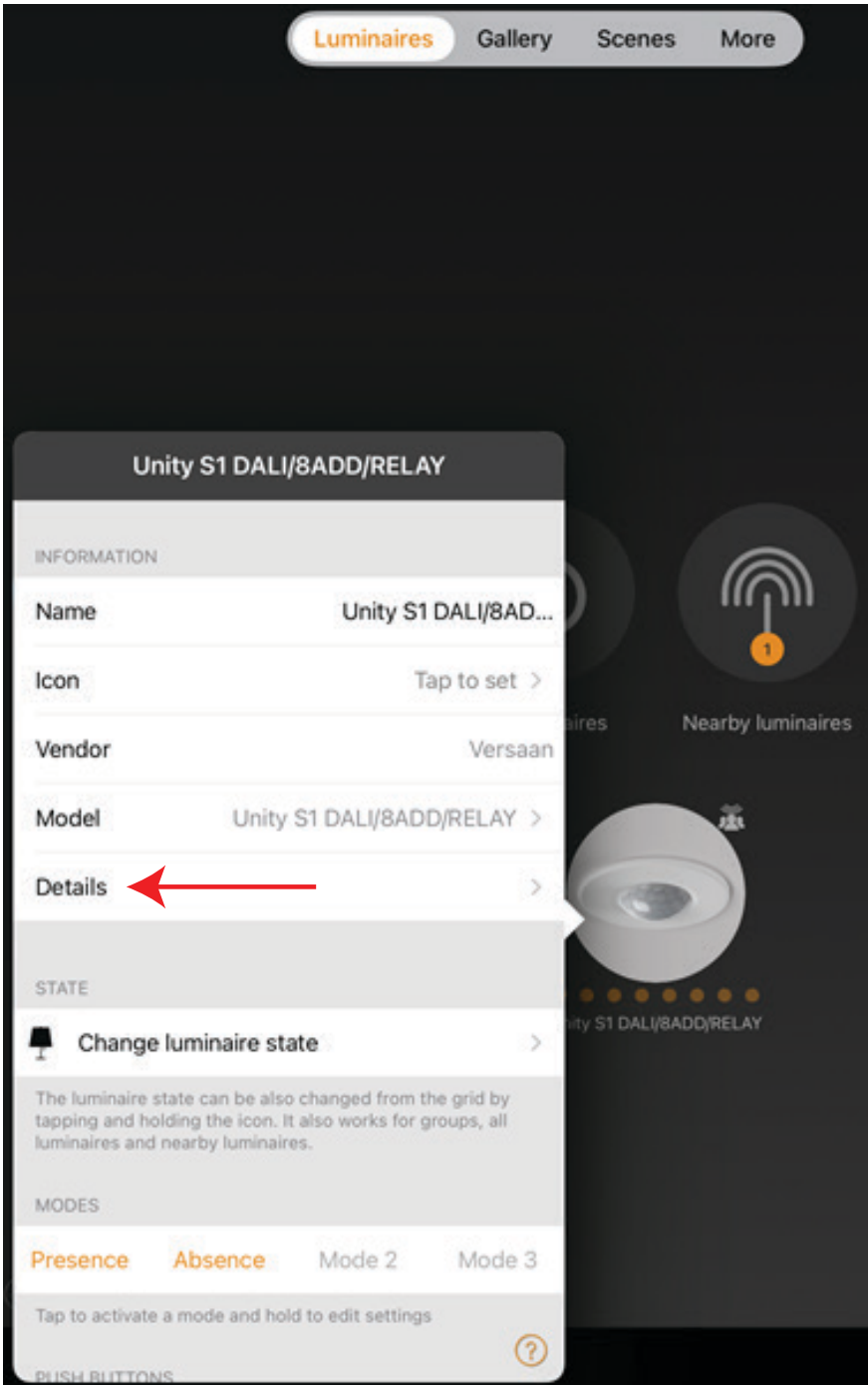

Double tap on the D1 DALI/8ADD/RELAY icon. Go to Details

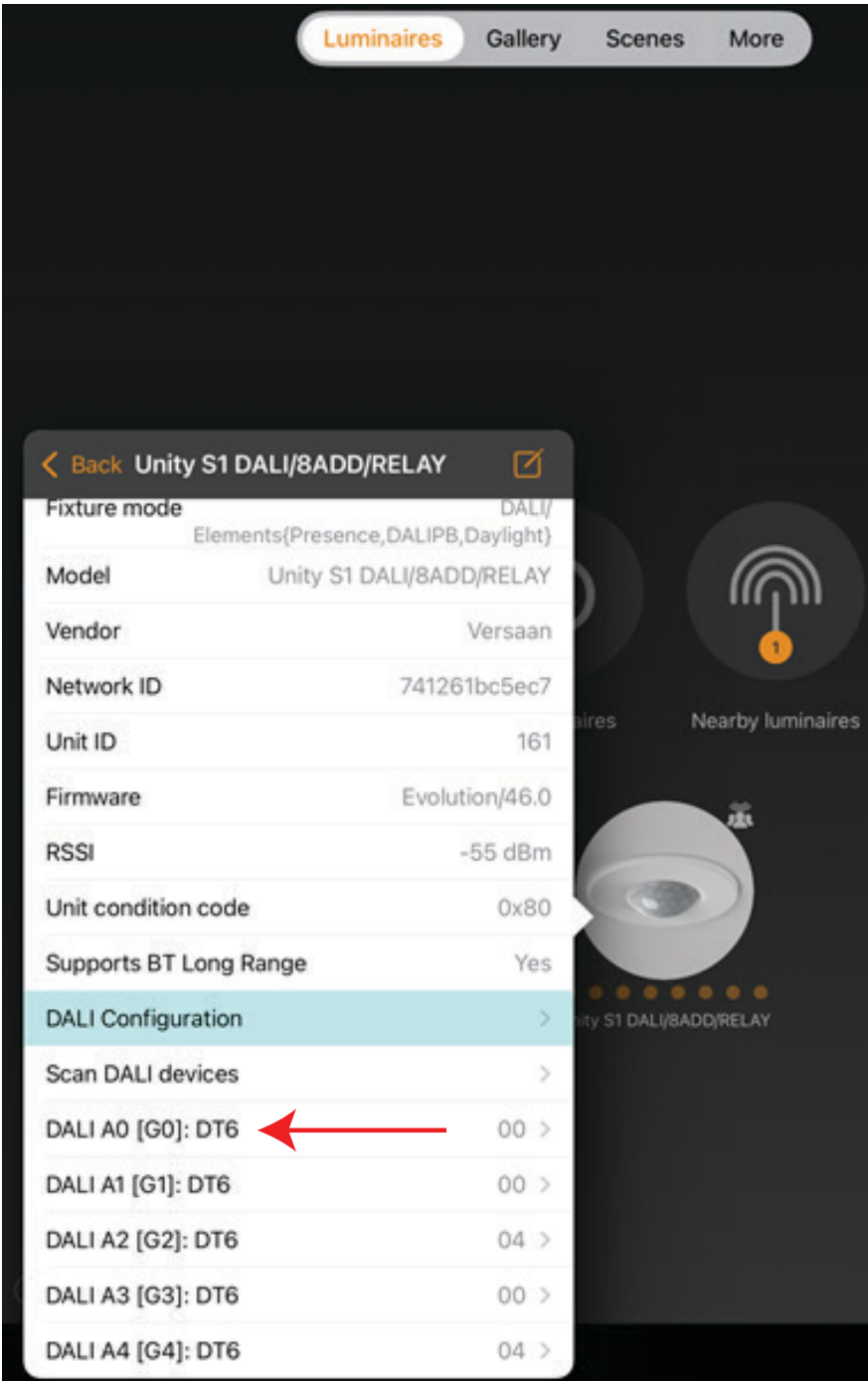

Scroll to the bottom of the list and you'll see a list of DALI devices connected to D1. This list takes time to generate sometimes so be patient. The list provides information on the: Devices Address (A0-A63) Devices Group (G0-G15) Type of DALI Device DT1,DT6,DT8 Eg the first DALI device listed is Address A0/ Group G0/Device Type DT6 Addresses are automatically assigned, Groups can only be assigned manually. Tap on the first DALI Device you want to change the address of



Tap on DALI Address. A box pops up showing available options. The most useful options are Identify the DALI devices Address, Identify Group, Change Address and Add or Remove from Group. Tap Change Address.

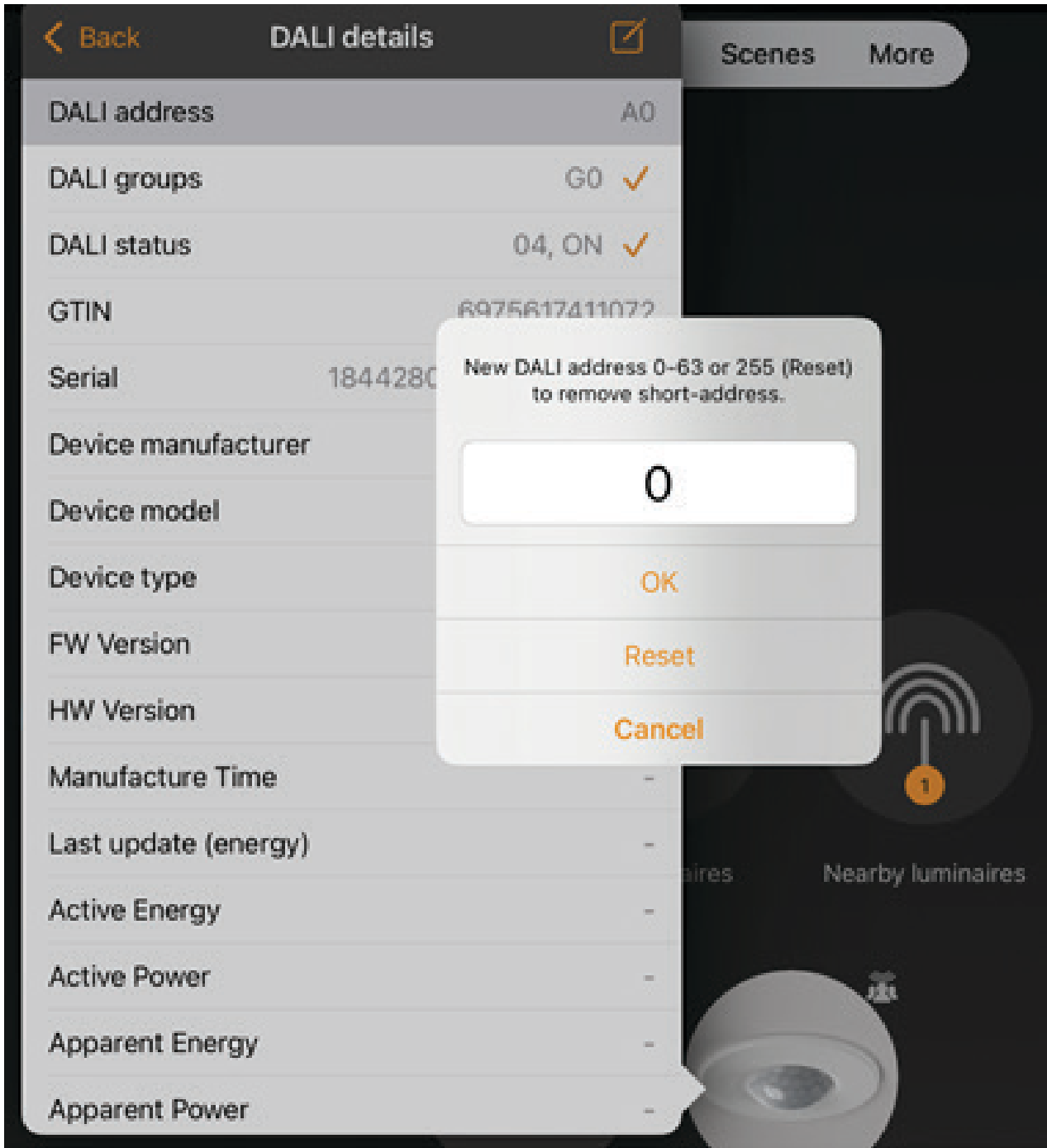

Select the Address you want to change the device too. A maximum of 8 Addresses (A0-A7) are useable in this profile. If you select an address that is already taken the system will assign the device with the current address to another address automatically. Return to the Details tab to see Address assignment.

43609 - Integral D1 DALI/8GRP/RELAY - Add or Remove DALI Group



Hold your finger over the D1 icon to bring up dimming options. In this profile upto 8 DALI Groups are controllable. Groups are listed from Group 0 (G0) to Group 7 (G7). The dimmers listed directly control the DALI devices based on what DALI group they have. The limitation is based on the maximum number of DALI devices D1 can control (upto 25). Up to 25 devices can be in one group or split across multiple groups. See next details for how to see what DALI devices have which group and how to change their group. Follow steps from 43961 until you reach "Tap on DALI Address".

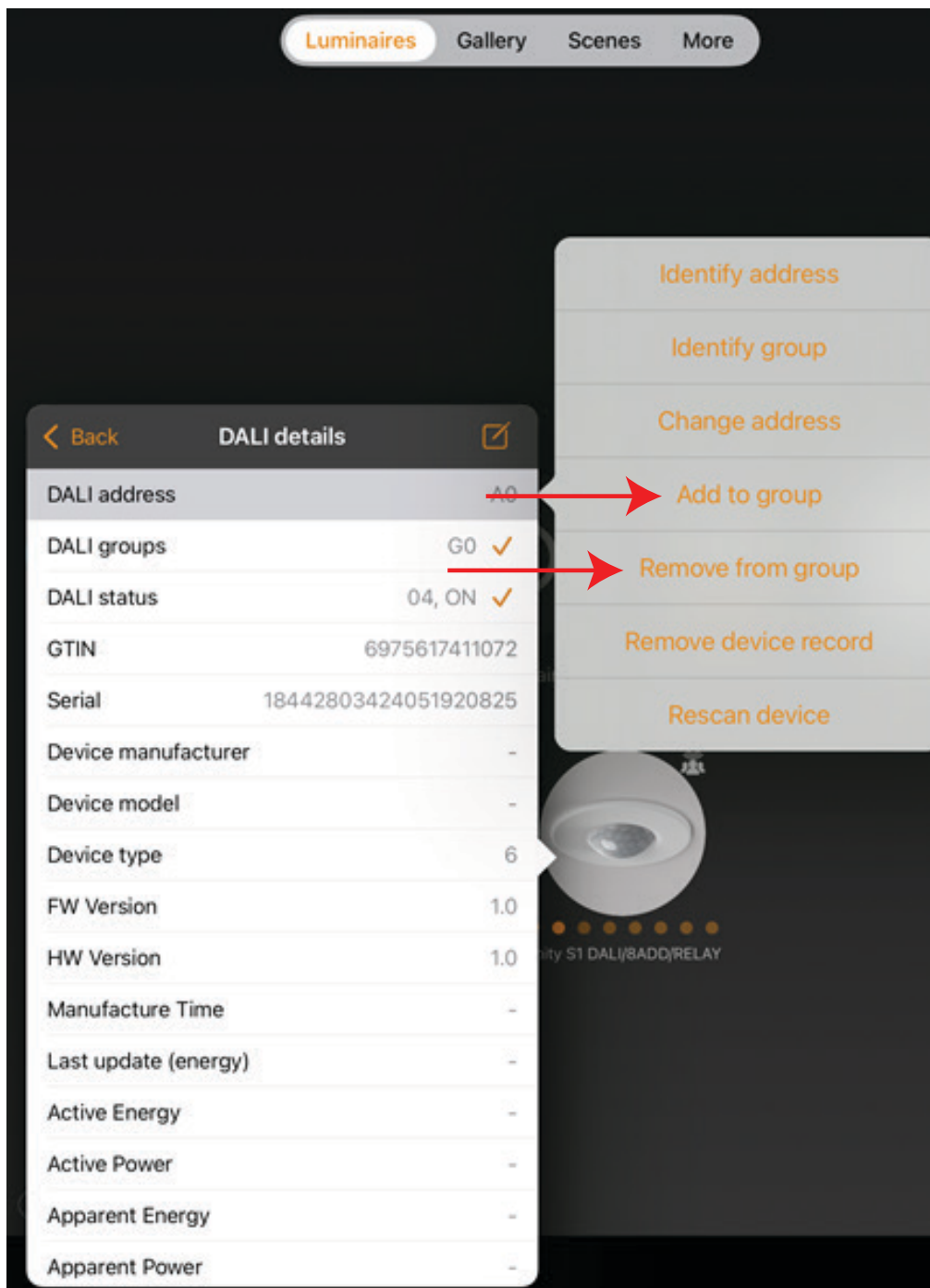

DALI devices can be Added or Removed from a group here. Click on the action you wish to perform.

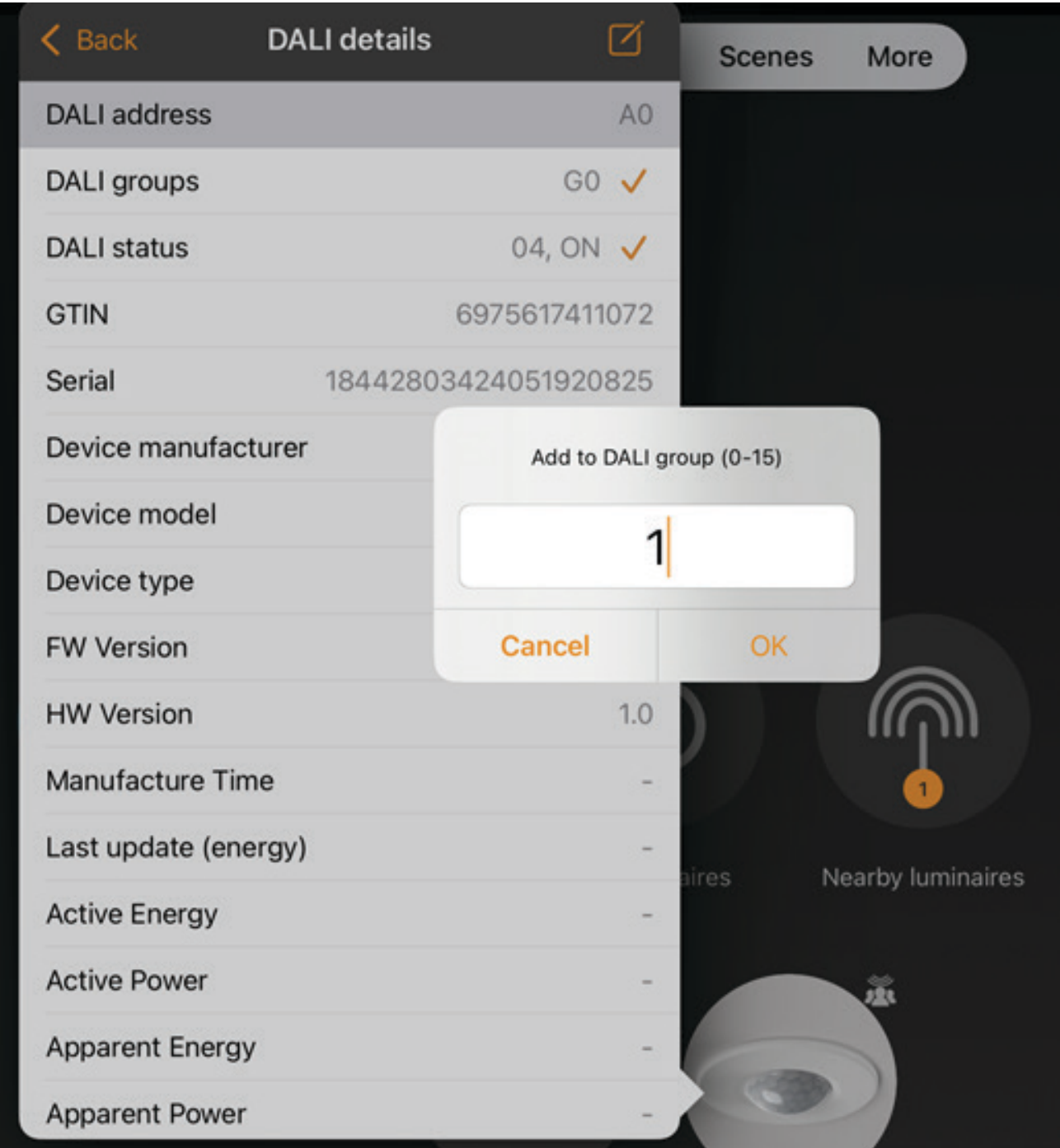

Add or Remove the devices from the group by choosing the group and tapping OK. Devices can be part of no group, 1 group or multiple depending on the type of control you require.