

EasyFix XChange Module

Replaceable LED lightsource XCD0130 & XCD0157

MEGAMAN®

PRODUCT DATASHEET

PRODUCT FEATURES

- Replaceable and Upgradeable light source and driver (MEGAMAN® XChange™ solution)
- Multi-CCT (3000K/4000K/6500K) by built-in switch
- Multi-lumen output selection (XCD0157 Version)
- Ultra high efficiency, Up to 155lm/w
- Extra-long lifetime up to 100,000 hours L80 B10 at Ta25°C; Extendable lifetime solution
- Upgradeable and future proof solution.
- Tool-less Plug-and-play modular design enhances flexibility
- All above features offer full aspect of flexibility of stock management
- Tool-less wiring thanks to push in terminal and connectors
- Homogenous light output with durable plastic cover avoiding yellowish deterioration
- Flicker Free $\leq 3\%$
- Power factor > 0.9
- Highly Compatible with conversational ceiling fixture and LED ceiling fixture
- Compatible with MEGAMAN RENZO XChange and FONDA XChange

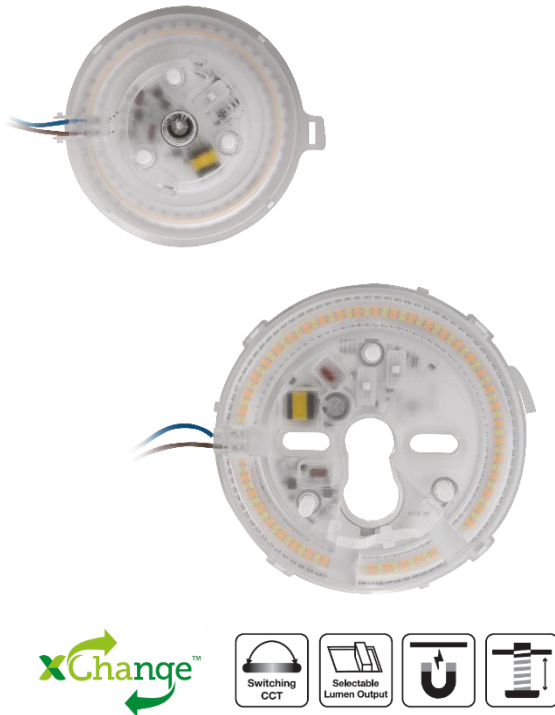

APPLICATIONS

- Living Rooms & Bathrooms
- Hotels
- Foyers
- Corridors
- Under Canopy
- Residential Application



EasyFix XChange Module

Replaceable LED lightsource XCD0130 & XCD0157



PRODUCT DATASHEET

GENERAL INFORMATION

Input Voltage / Frequency	220-240 VAC / 50-60Hz Compatible with DC180-260V
Power Supply Unit	Drive on Board
Light Source	MEGAMAN® XChange™ module (Replaceable)
Energy efficiency	Class D
Dimmability	No
CRI	≥ 80
Beam Angle	150°
Colour Consistency	SDCM ≤ 6
Lifetime	100 000hrs L80 B10 at 25°C
Number of Switching Cycles	> 100 000
Light source category	Built-in light source module
Insulation	The insulation type between active parts of LED module and the mounting surface of the LED module is reinforced insulation based on 250 V~.
Glow Wire	650°C
Photobiological Safety Group	RG 0
Flicker percentage	≤ 3% at 100Hz
Working Temperature	-30°C to +40°C Standard
Material & Colour	Polypropylene.Base, Polycarbonate optics
Installation	Conventional Ceiling Lamp ; RENZO XChange ; FONDA XChange
Approvals	EN60598-1, EN60598-2-1, EN62493, EN62471, EN60598-2-22, EN55015, EN61547, EN61000-3-2, EN61000-3-3

EasyFix XChange Module

Replaceable LED lightsource XCD0130 & XCD0157

MEGAMAN®

PRODUCT DATASHEET

PRODUCT INFORMATION

Model No.	MM Code	Power W	Luminous Flux lm	Luminous Efficacy lm / W	Current mA	Mounting Interface
XCD0130AMv00-sc+WB01	-	10	1150 [3000K] 1250 [4000K/6500K]	115 [3000K] 125 [4000K/6500K]	50	XCD0130A or conventional
XCD0130 El nr 37 021 95	712491 / MM12491	10	1250 [3000K] 1400 [4000K/6500K]	125 [3000K] 140 [4000K/6500K]	50	XCD0130A or conventional
XCD0157AMv00-ds/sc+WB02	-	20/15/10	2600/1950/1300 [3000K] 2900/2175/1450 [4000K/6500K]	130 [3000K] 145 [4000K/6500K]	95/70/50	XCD0157A or conventional
XCD0157 El nr 37 005 38	712492 / MM12492	20/15/10	2800/2100/1400 [3000K] 3100/2330/1550 [4000K/6500K]	140 [3000K] 155 [4000K/6500K]	95/70/50	XCD0157A or conventional



XCD0130A0v00-sc+WB01



XCD0130A0v01-sc+WB01



XCD0157A0v00-ds-sc+WB02

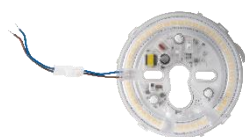

XCD0157AMv01-ds-sc+WB02

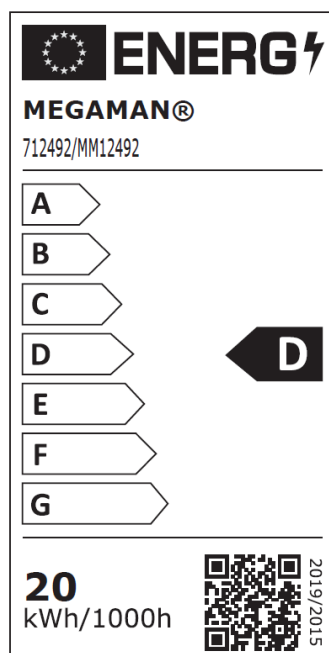
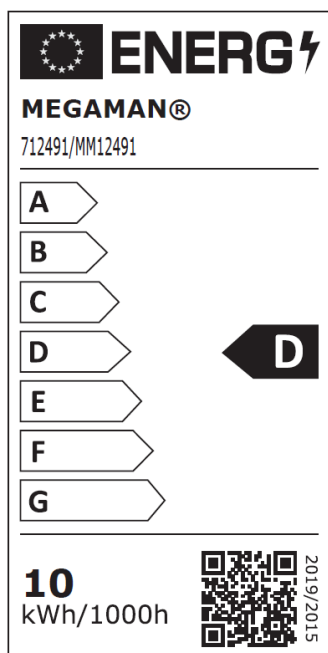

EasyFix XChange Module

Replaceable LED lightsource XCD0130 & XCD0157

MEGAMAN®

PRODUCT DATASHEET

WIRING

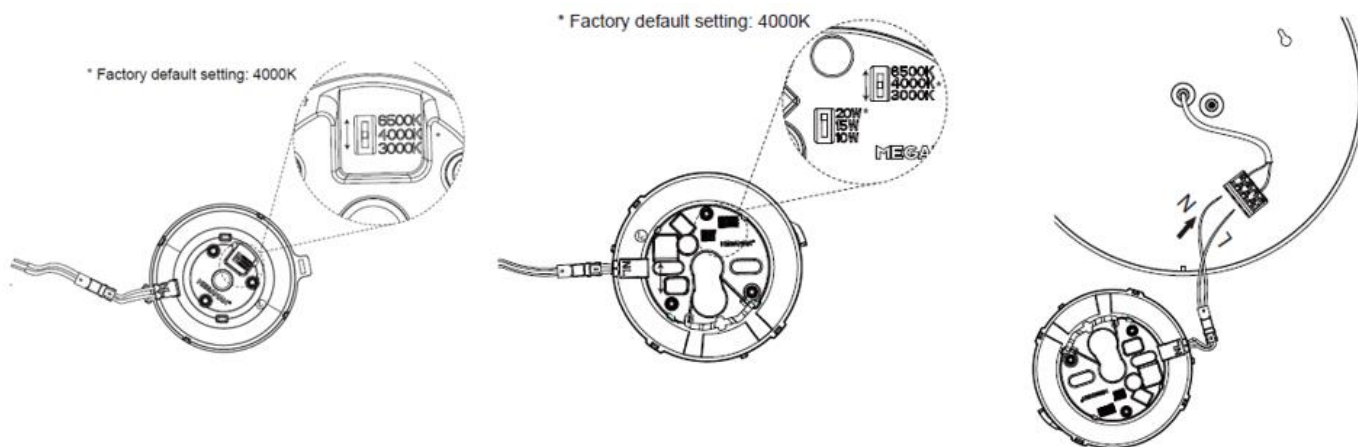

Installation with conversional ceiling lamp:

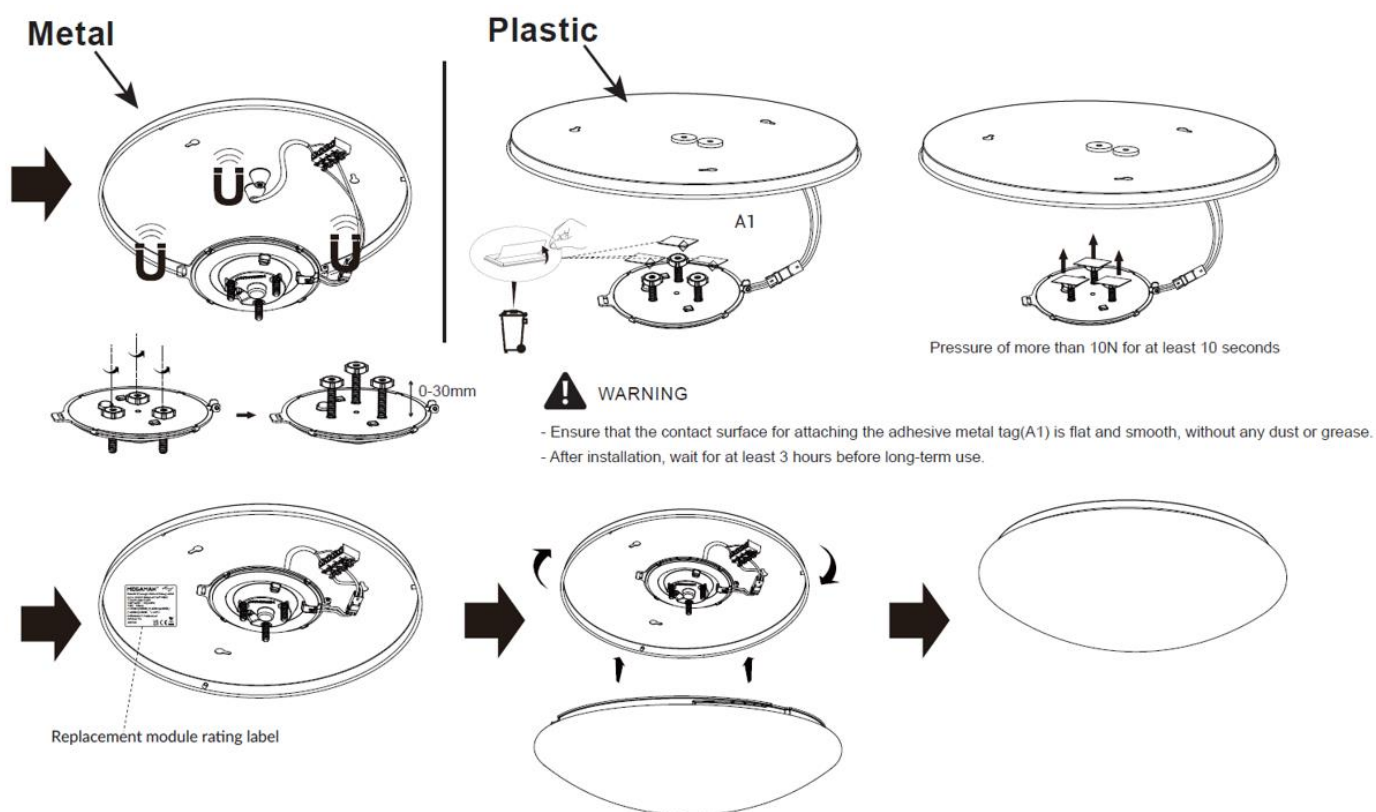

EasyFix XChange Module

Replaceable LED lightsource XCD0130 & XCD0157

MEGAMAN®

PRODUCT DATASHEET

Installation with MEGAMAN® RENZO XChange and FONDA XChange

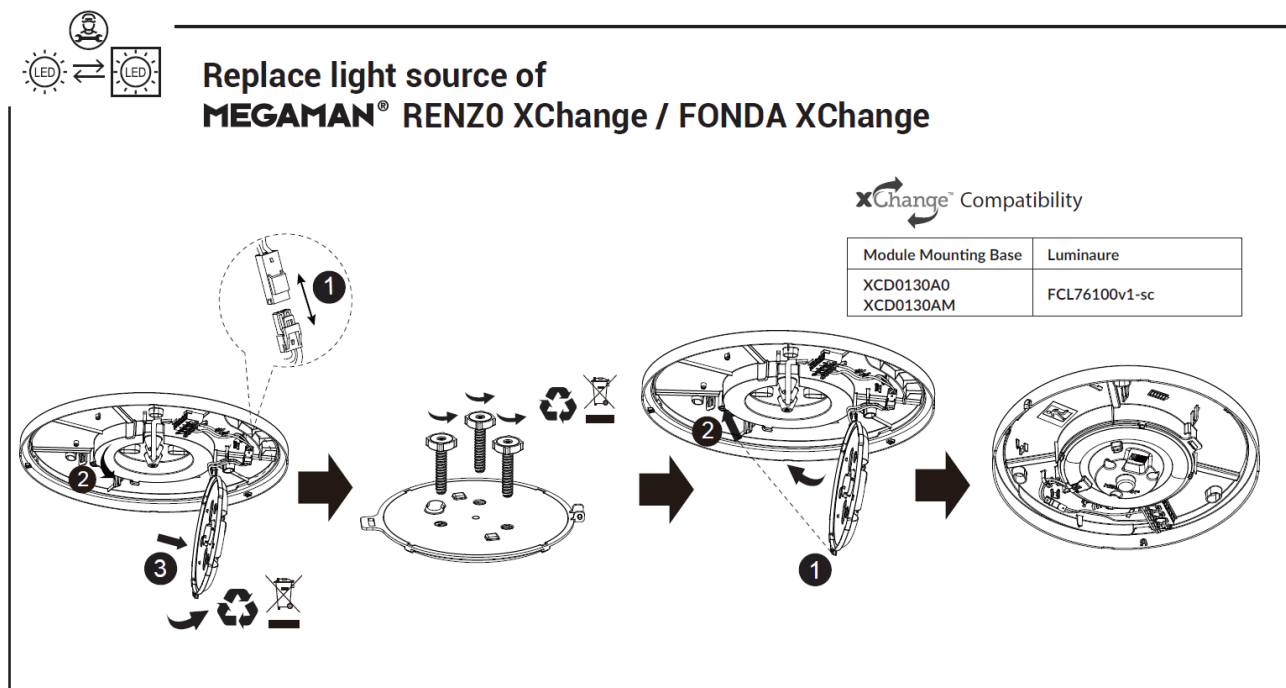

Model No.	Inrush Current	Inrush Duration	Max. no. of Luminaire Connection on MCB			
	A	µs	B10	B16	C10	C16
XCD0130AMv00-sc+WB01	5	19.6	79	84	85	99
XCD0130AMv01-sc+WB01	5	19.6	79	84	85	99
XCD0157AMv00-ds/sc+WB02	5.12	21.6	46	46	46	51
XCD0157AMv01-ds/sc+WB02	5.12	21.6	46	46	46	51

DIMENSIONS & WEIGHT

Model No.	D mm	H mm	Weight g
XCD0130AMv00-sc+WB01	148	41	140
XCD0130AMv01-sc+WB01	148	41	140
XCD0157AMv00-ds/sc+WB02	163	39.5	210
XCD0157AMv01-ds/sc+WB02	163	39.5	210

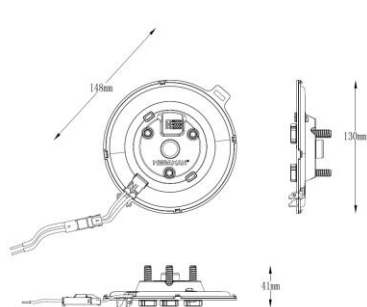

XCD0130AMv00-sc+WB01
XCD0130AMv01-sc+WB01

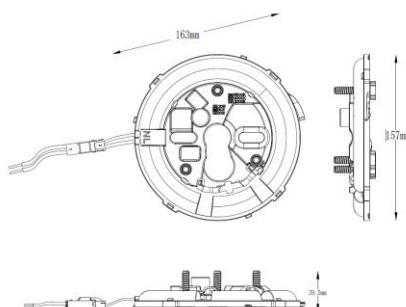

XCD0157AMv00-ds/sc+WB02
XCD0157AMv01-ds/sc+WB02

EasyFix XChange Module

Replaceable LED lightsource XCD0130 & XCD0157

MEGAMAN®

PRODUCT DATASHEET

LOGISTIC DATA

Model No.	Packaging Unit	Outer Box Dimensions			Gross Weight per Outer Box
		L	W	H	
	pcs/unit	mm	mm	mm	kg
XCD0130AMv00-sc+WB01	20	346	286	314	4.87
XCD0130AMv01-sc+WB01	20	346	286	314	4.87
XCD0157AMv00-ds/sc+WB02	20	356	246	364	5.66
XCD0157AMv01-ds/sc+WB02	20	356	246	364	5.66

ADDITIONAL INFORMATION

Rated lifetime L70/B50 at 25 °C	100000h
Rated lifetime L80/B10 at 25 °C	100000h
Lumen maintenance at median useful life of 35,000 h at 25 °C ambient (tq)	90%
Lumen maintenance at median useful life of 50,000 h at 25 °C ambient (tq)	85%
Lumen maintenance at median useful life of 75,000 h at 25 °C ambient (tq)	80%
Failure rate at median useful life of 35,000 h at 25 °C ambient (tq)	10%
Failure rate at median useful life of 50,000 h at 25 °C ambient (tq)	10%
Flickering value Pst LM	1
Stroboscope effect value SVM	0.4
Luminous intensity	544cd max
Total harmonic distortion (THD)	20%
Suitable for emergency lighting	Yes, Compatible with 180-260VDC
Constant light output (CLO)	Yes

DISCLAIMER

Subject to change without notice. Errors and omissions excepted. Always ensure you are using the most recent release.

EasyFix XChange Module

Replaceable LED lightsource XCD0130 & XCD0157

MEGAMAN®

PRODUCT DATASHEET



Super Quick Simple and Cost-Effective Maintenance

Thanks to our All-in-One module design, there is no need to identify individual component faults. Simply replace the entire XChange™ LED module within 10 seconds, without the need for tools or rewiring. This approach can be more cost-effective over time.



Extended Lifespan

LED luminaires with replaceable MEGAMAN® XChange™ light sources module can have a longer overall lifespan because the XChange™ light source can be replaced without needing to replace the entire fixture.



Flexibility in Light Quality

Users can choose different settings with selectable colour temperature and lumen output. As well as different LED modules with varying efficacy(lm/w), optics and colour rendering indices (CRI) to suit their specific needs and preferences.



Cross-Platform Compatibility

MEGAMAN® XChange™ light module is designed to fit not only dedicated same fixtures but also luminaires in various series and generation across MEGAMAN®, offering versatile and seamless integration.



Sustainability

By replacing only the light source rather than the entire luminaire, minimize the waste created, making it a more environmentally friendly option.



Ease of Upgrade

As LED technology advances, you can easily upgrade to newer, more efficient XChange™ LED modules without changing the entire luminaire.



Reduced Downtime

In professional settings, replaceable light sources can minimize downtime since maintenance can be performed quickly and easily. This is particularly beneficial for property management projects.



Customization

Users can tailor the lighting to different applications and environments by selecting appropriate XChange™ LED modules.



Future-Proof Solution

With the growing emphasis on reparability in tenders, projects, and funding programs, replaceable light source LED luminaires are designed to meet these requirements. This ensures they remain compliant with evolving regulations and standards.